

**Design Intent:**

Create a beautiful planted berm to mitigate the borrowed view toward the neighbor's home. By mixing flowering shrubs to attract butterflies with large evergreen trees and shrubs, adding redwoods for grand scale and fast screening, and then blanketing the with banks of flowering perennials all with golden fall color, this easy-care/four-season bed makes a great solution.

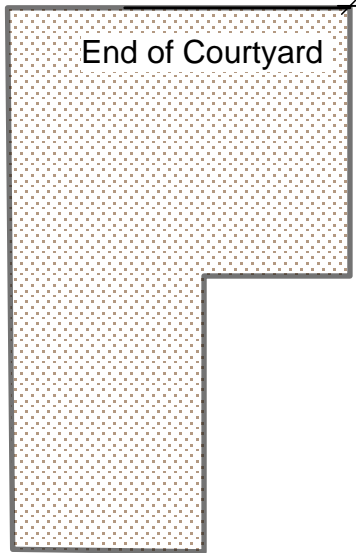
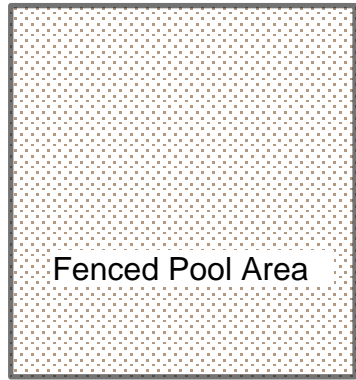

40'-0"

20'-0"

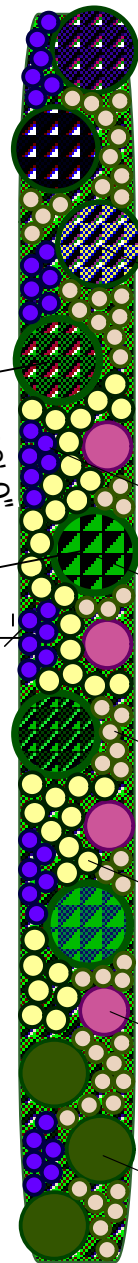

3 Deodar Cedar

36 Agastache 'Blue Fortune'

4 Dawn Redwood

55 'Karley Rose' Grass

40 Amsonia hubrichtii

4 Butterfly Bush

3 Leatherleaf Viburnum



SCALE: 1" = 20'-0"  
DWN: SLS